

I Пенал навісний / Пенал навесной / Wall Cabinet

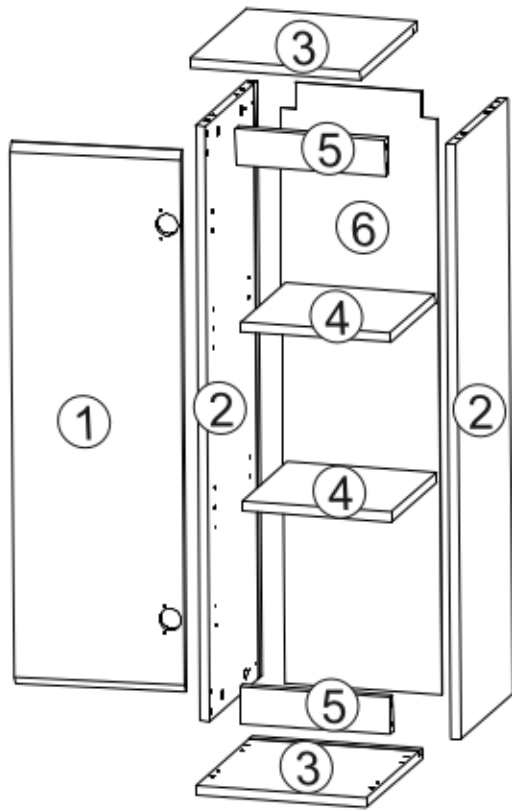

2x



| A | B | C | D |
|---|---------|-----|---------|
| 1 | LU1-001 | 884 | 274 1/2 |
| 2 | LU1-101 | 970 | 284 1/2 |
| 3 | LU1-201 | 280 | 306 1/2 |
| 4 | LU1-301 | 244 | 246 1/2 |
| 5 | LU1-401 | 246 | 60 1/2 |
| 6 | LU1-901 | 258 | 982 1/2 |

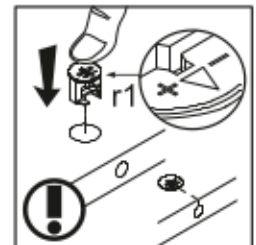
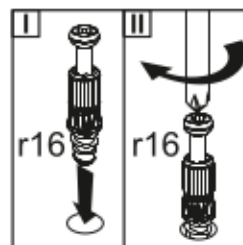
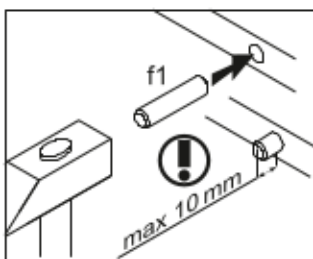
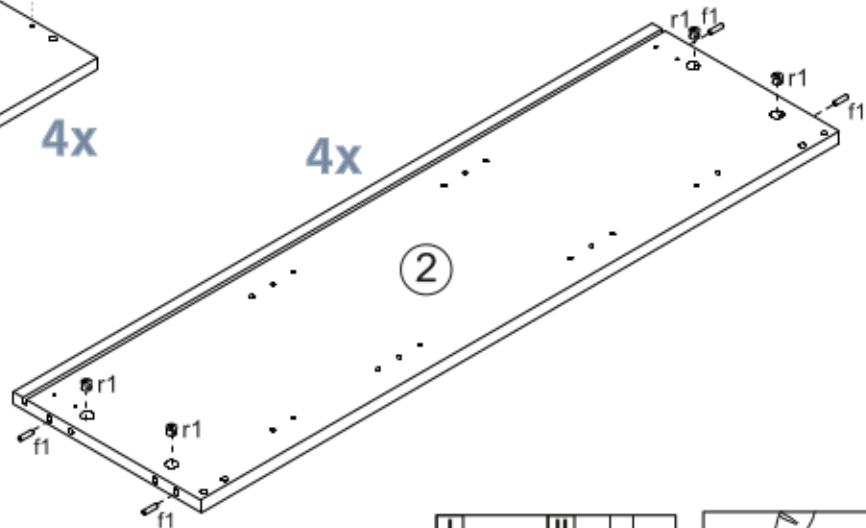
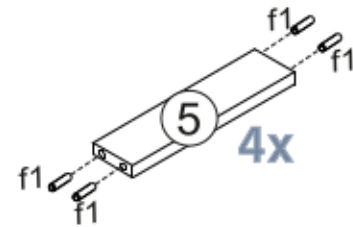
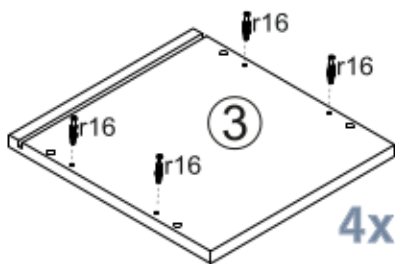
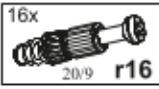
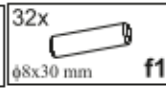

2



2x

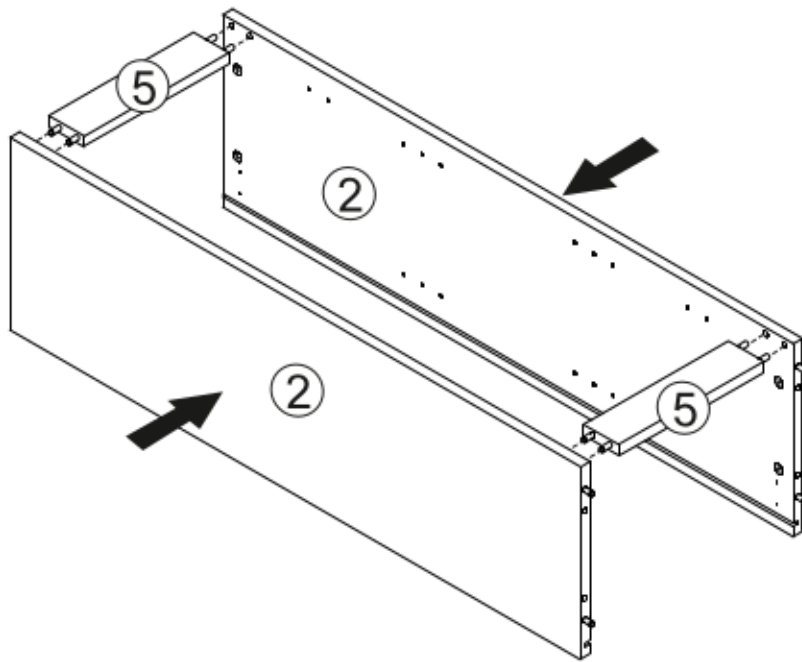

3

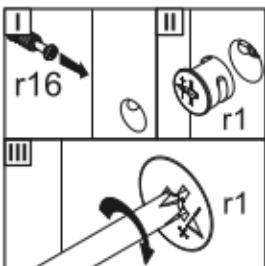
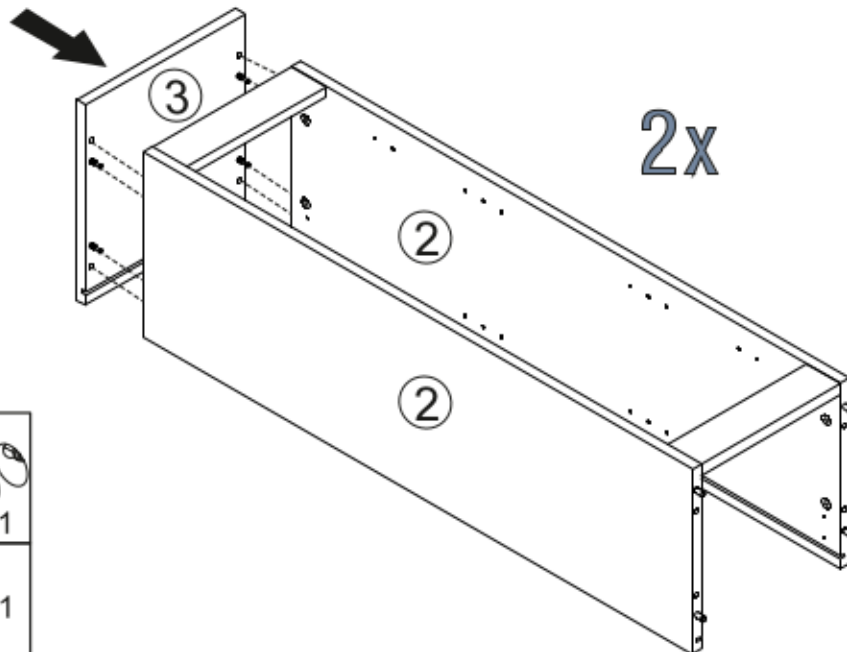

4

2x

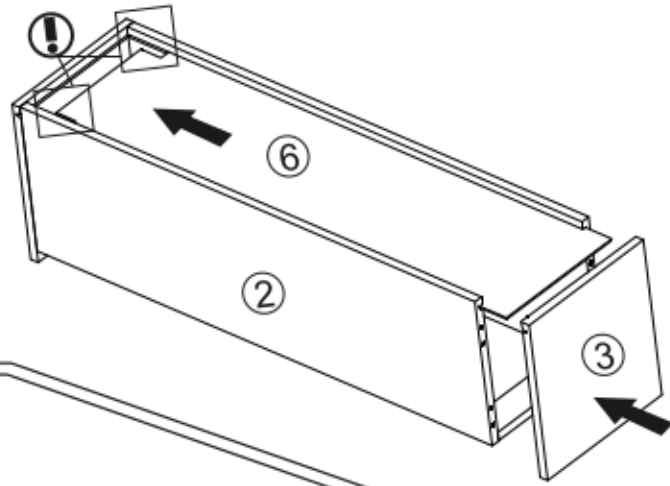
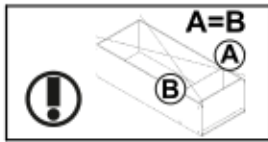

5



2x

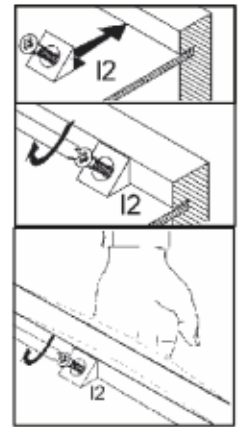
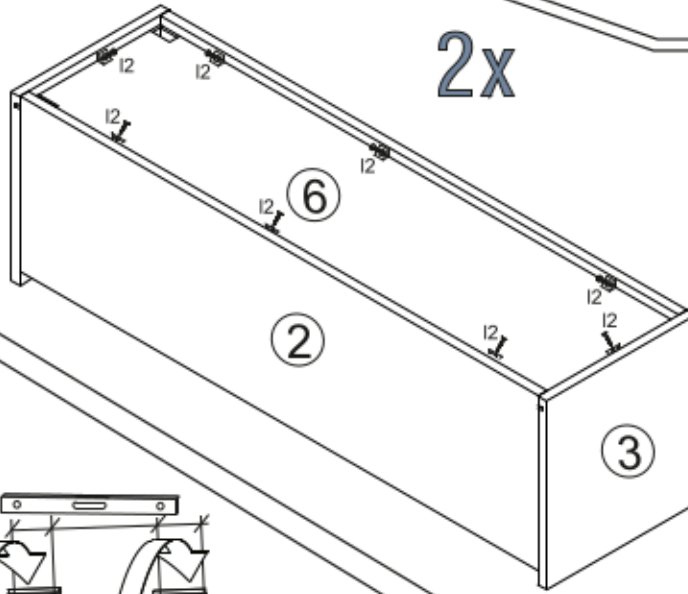
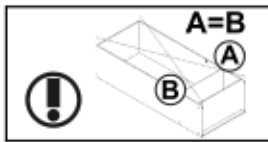

6

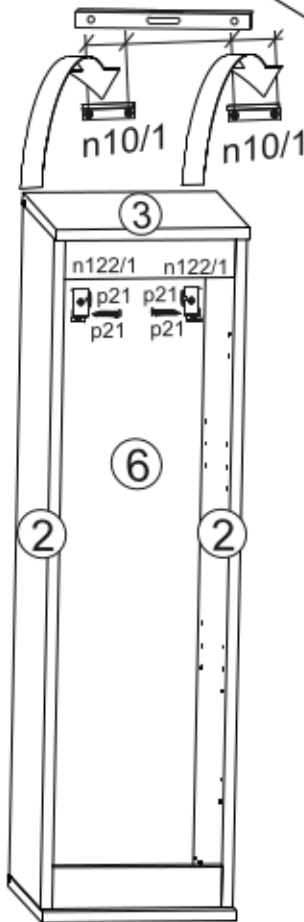
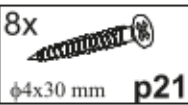
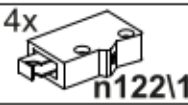
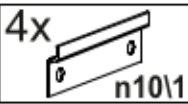
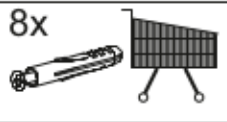

2x

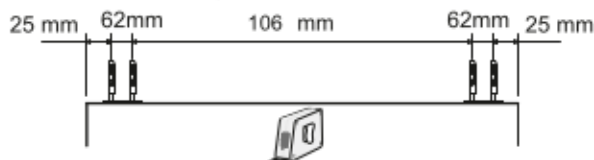
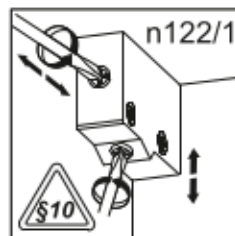
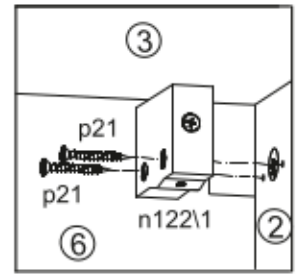
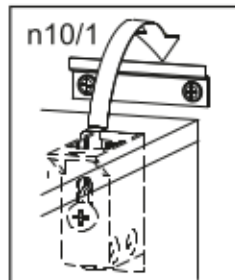
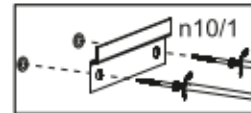
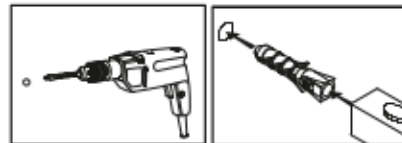

7

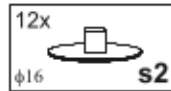
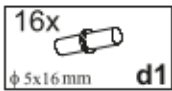

2x



REG1D_L

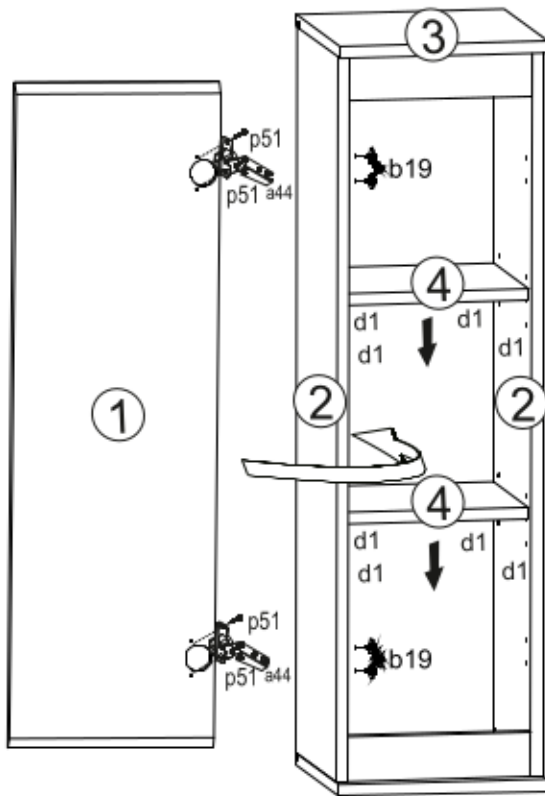

REG1D_P

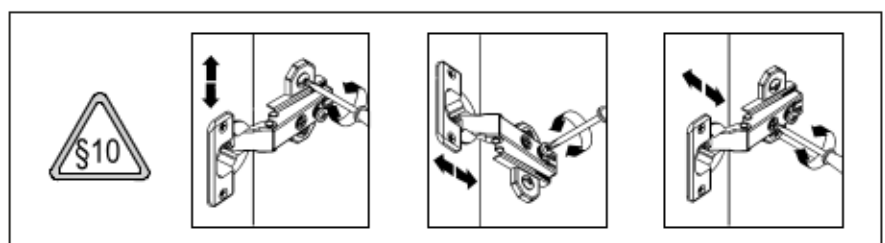
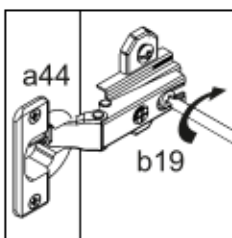
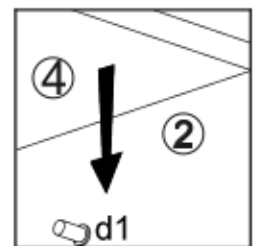
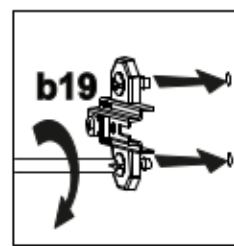
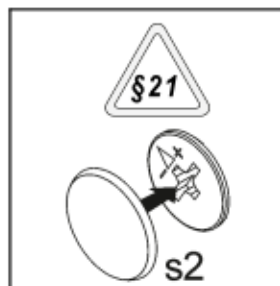
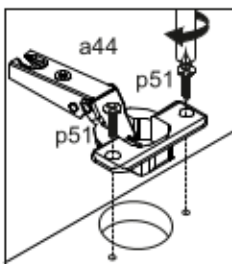
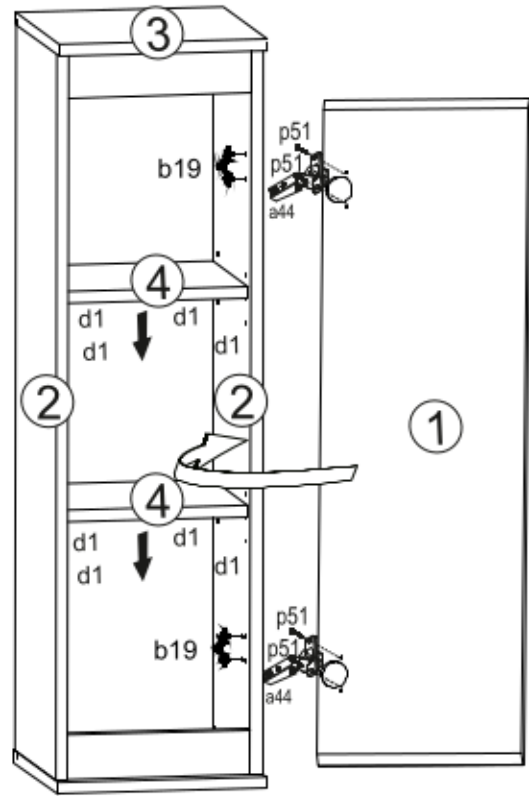

II Тумба / Тумба / TV stand

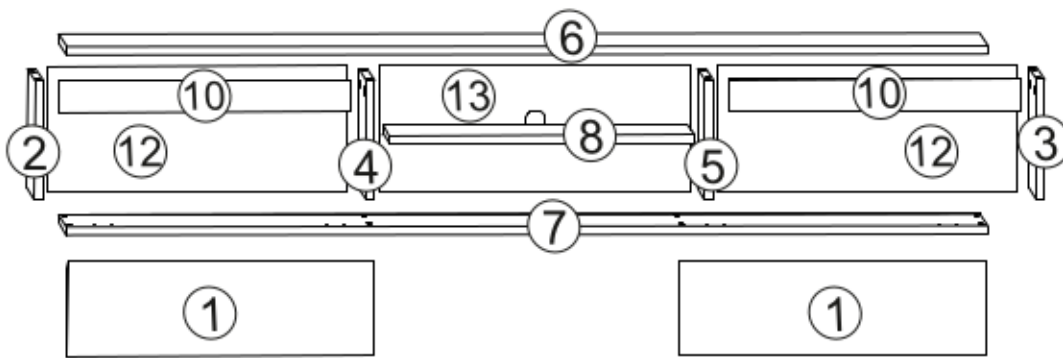

| A | B | C | D | A | B | C | D | | |
|---|---------|------|-----|-----|----|---------|------|-----|-----|
| 1 | LU1-002 | 582 | 181 | 2/2 | 7 | LU1-203 | 1752 | 370 | 2/2 |
| 2 | LU1-102 | 227 | 348 | 2/2 | 8 | LU1-302 | 576 | 318 | 2/2 |
| 3 | LU1-103 | 227 | 348 | 2/2 | 10 | LU1-402 | 554 | 60 | 2/2 |
| 4 | LU1-104 | 227 | 328 | 2/2 | 12 | LU1-902 | 568 | 240 | 2/2 |
| 5 | LU1-105 | 227 | 328 | 2/2 | 13 | LU1-903 | 594 | 240 | 2/2 |
| 6 | LU1-202 | 1752 | 370 | 2/2 | | | | | |

1

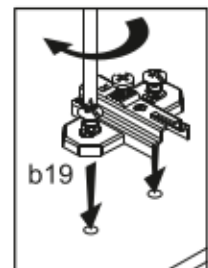
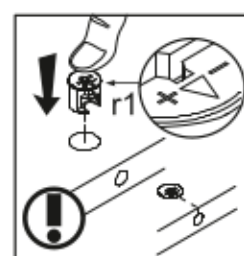
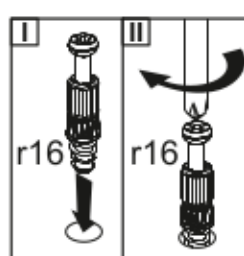
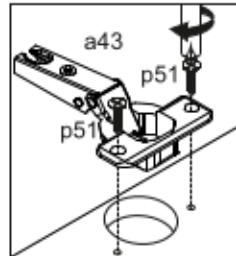
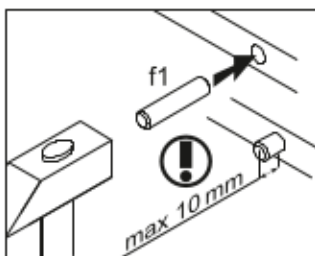
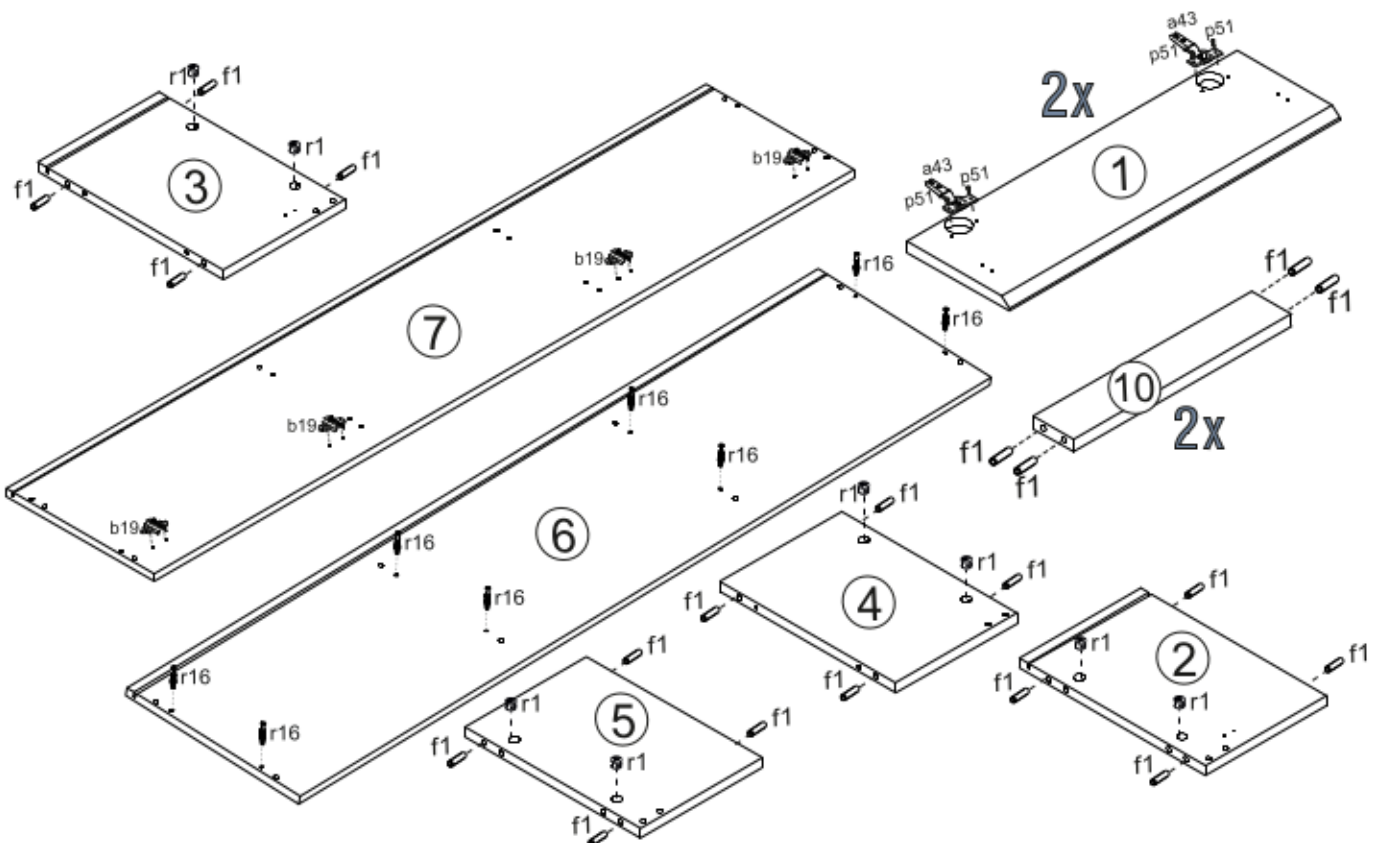
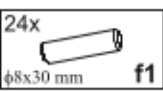

2

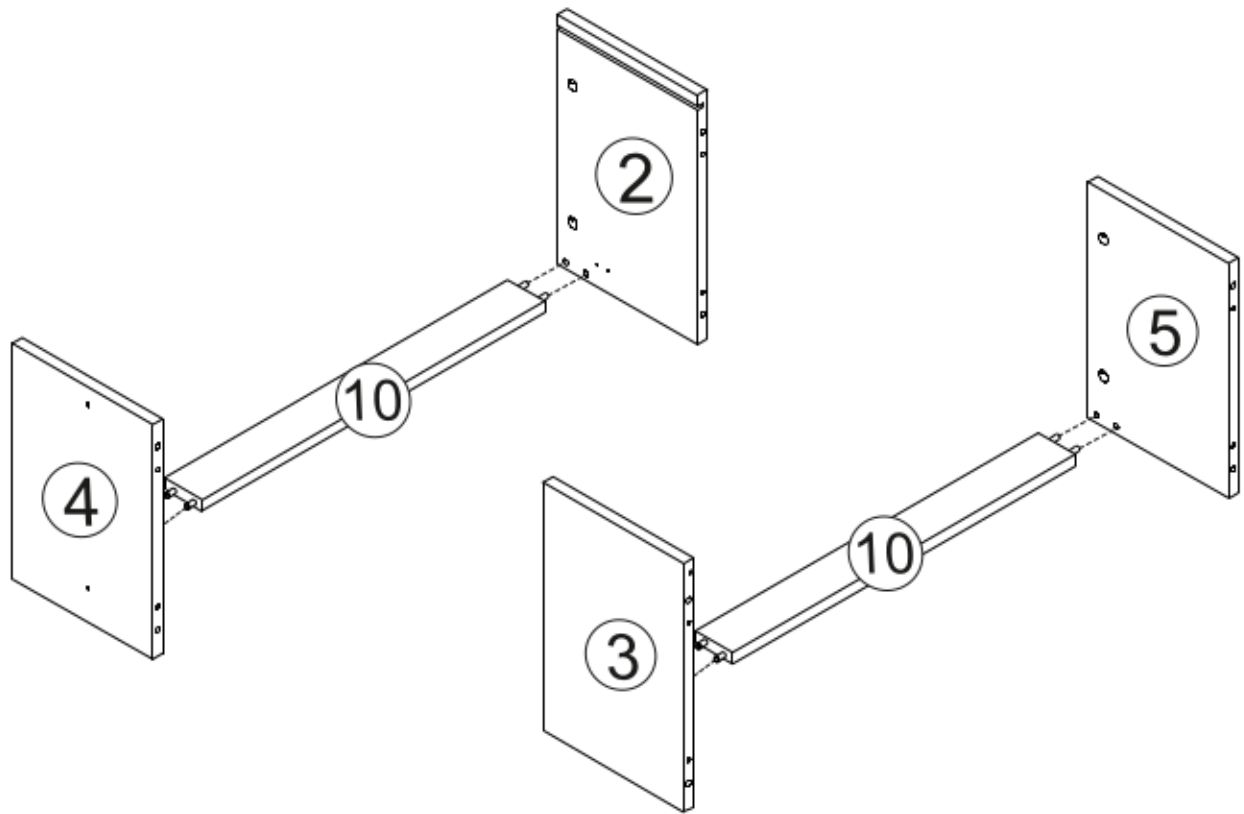

3

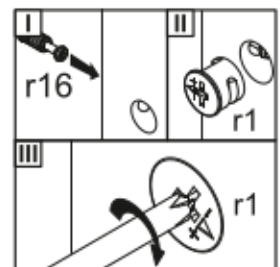
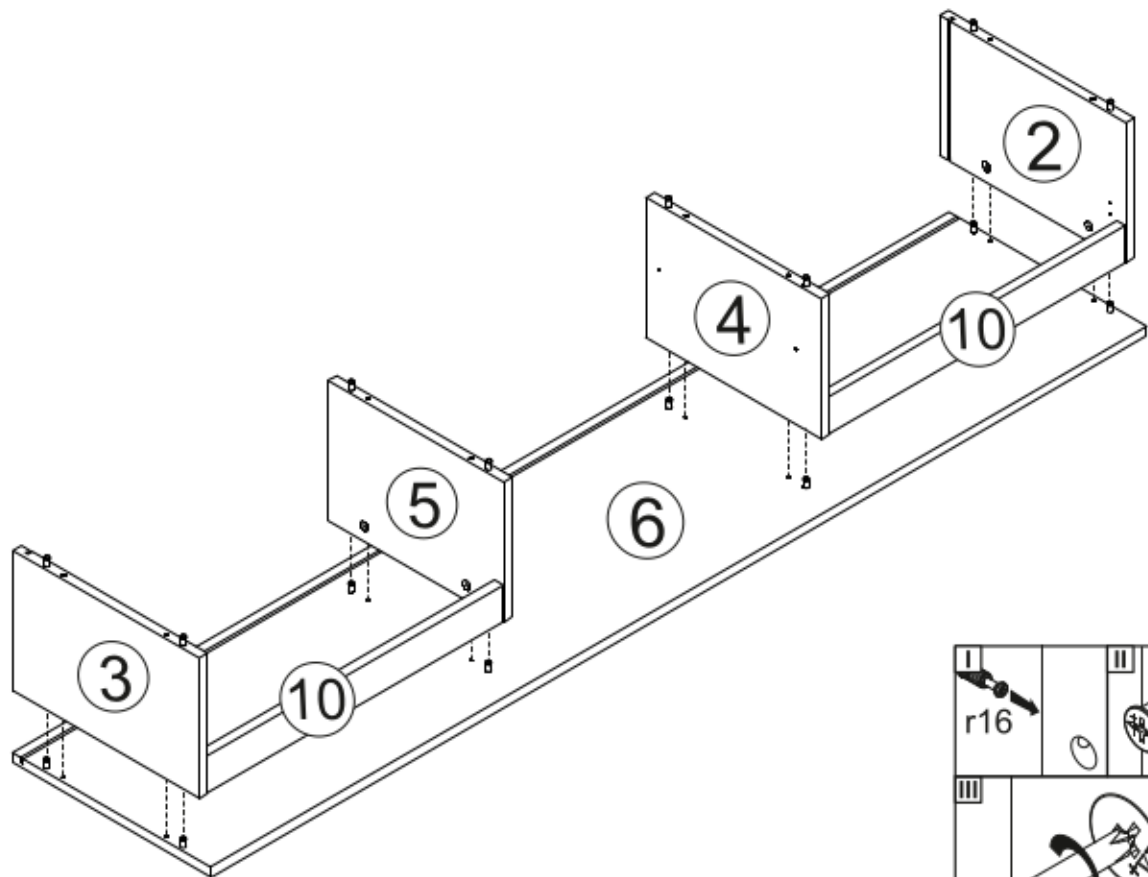

4

8x
φ7x50 mm e1

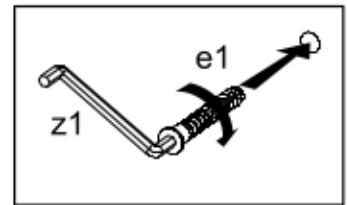
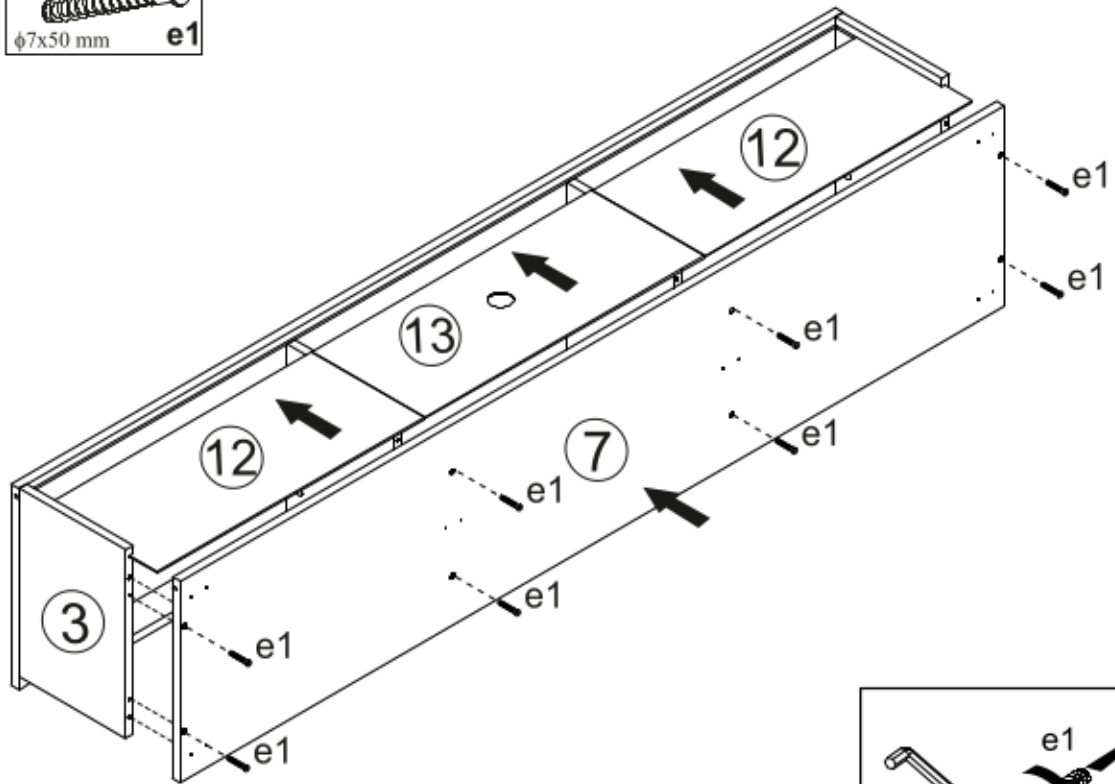

5

6x
k55

12x
φ4x35 mm p6

4x
20x13x3,5/1 mm n108

4x
φ2,9x16 mm p55

14x
I2

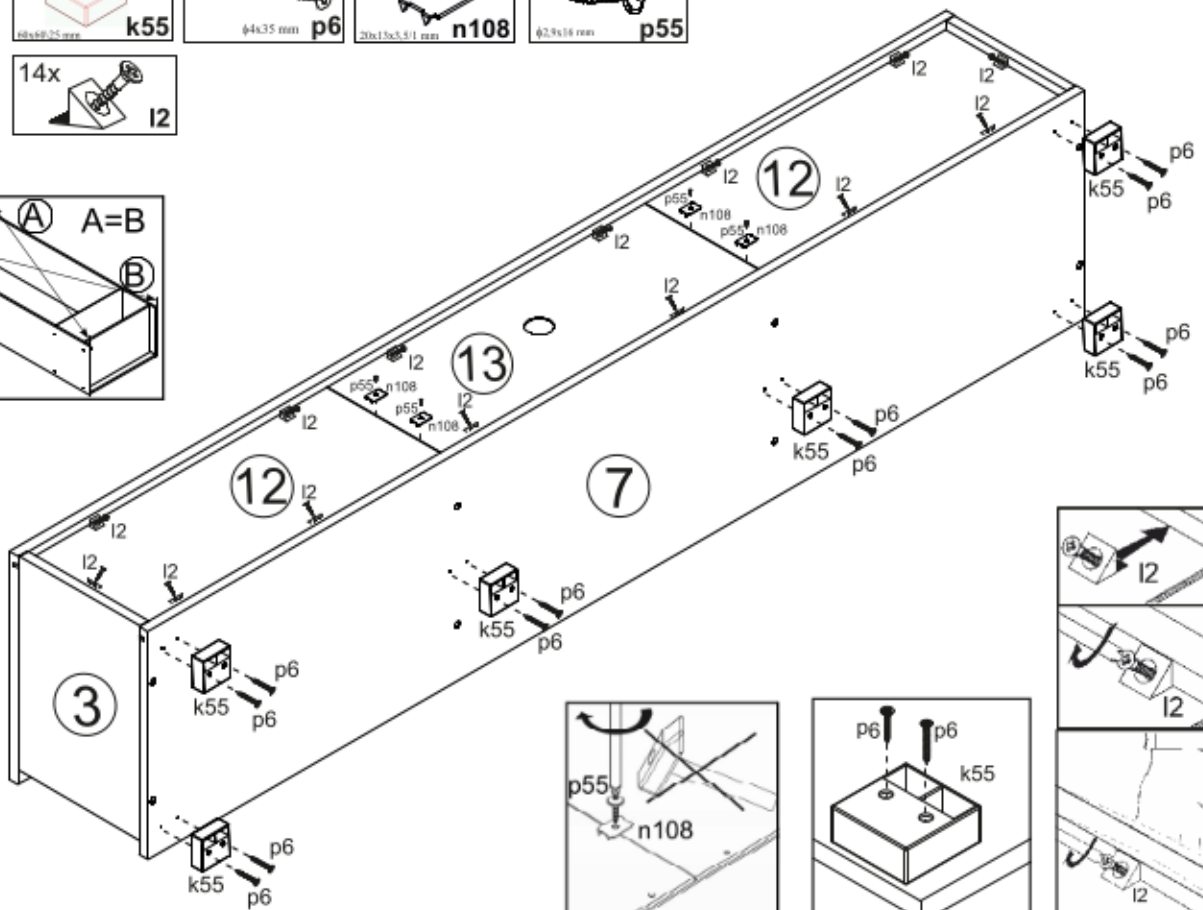
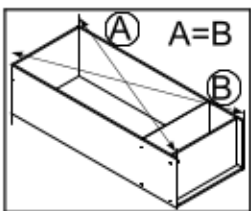

6

8x $\phi 3,5 \times 13$ mm p1

4x $\phi 5 \times 16$ mm d1

2x L-230 m48

8x $\phi 16$ s2

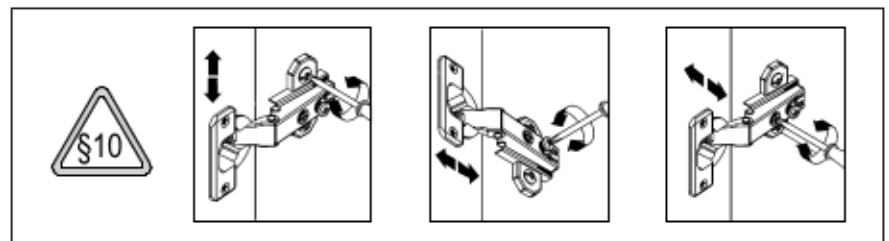
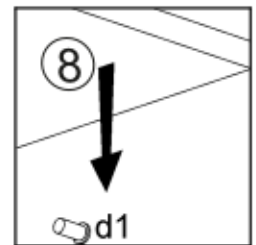
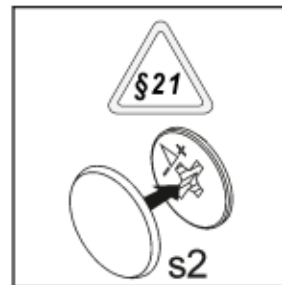
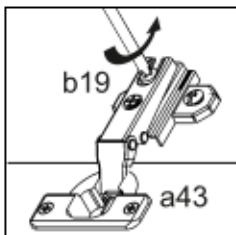
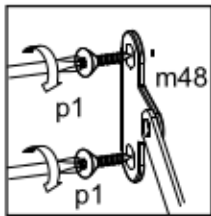
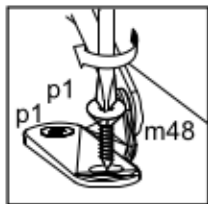
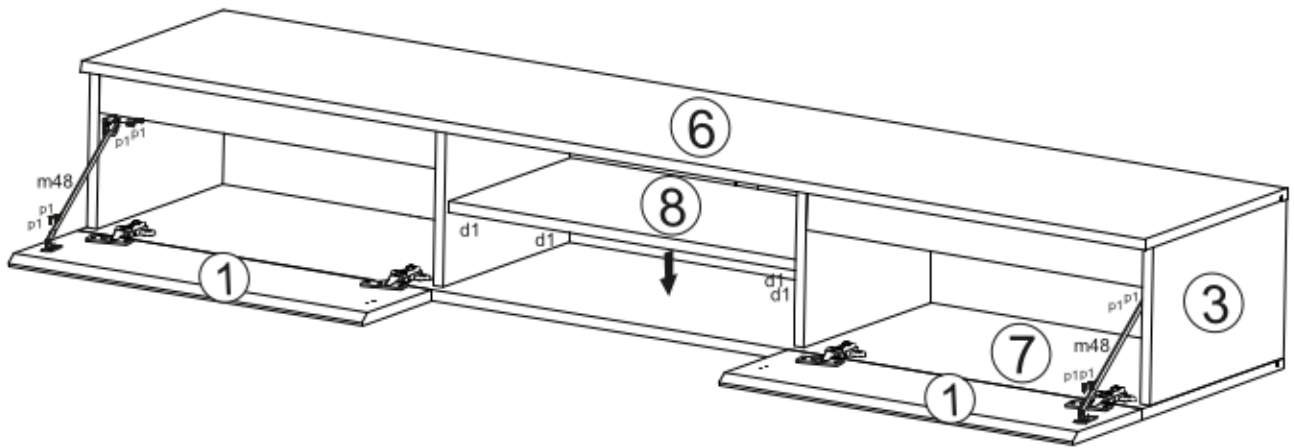



Полиця / Полка / Shelf

max
3kg

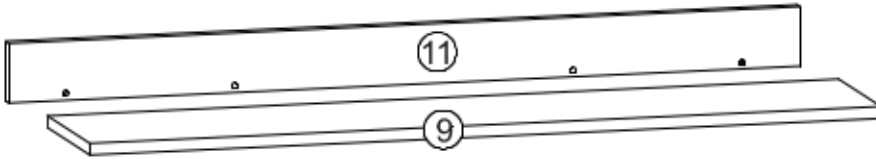

1

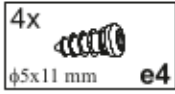
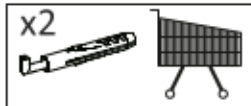

| A | B | C | D |
|----|---------|-----|---------|
| 9 | LU1-303 | 882 | 144 2/2 |
| 11 | LU1-403 | 982 | 150 2/2 |

